

REV	ECO	BY	DESCRIPTION	APV	DATE
A	5386	DJP	INITIAL DESIGN	JJB	3/24/20

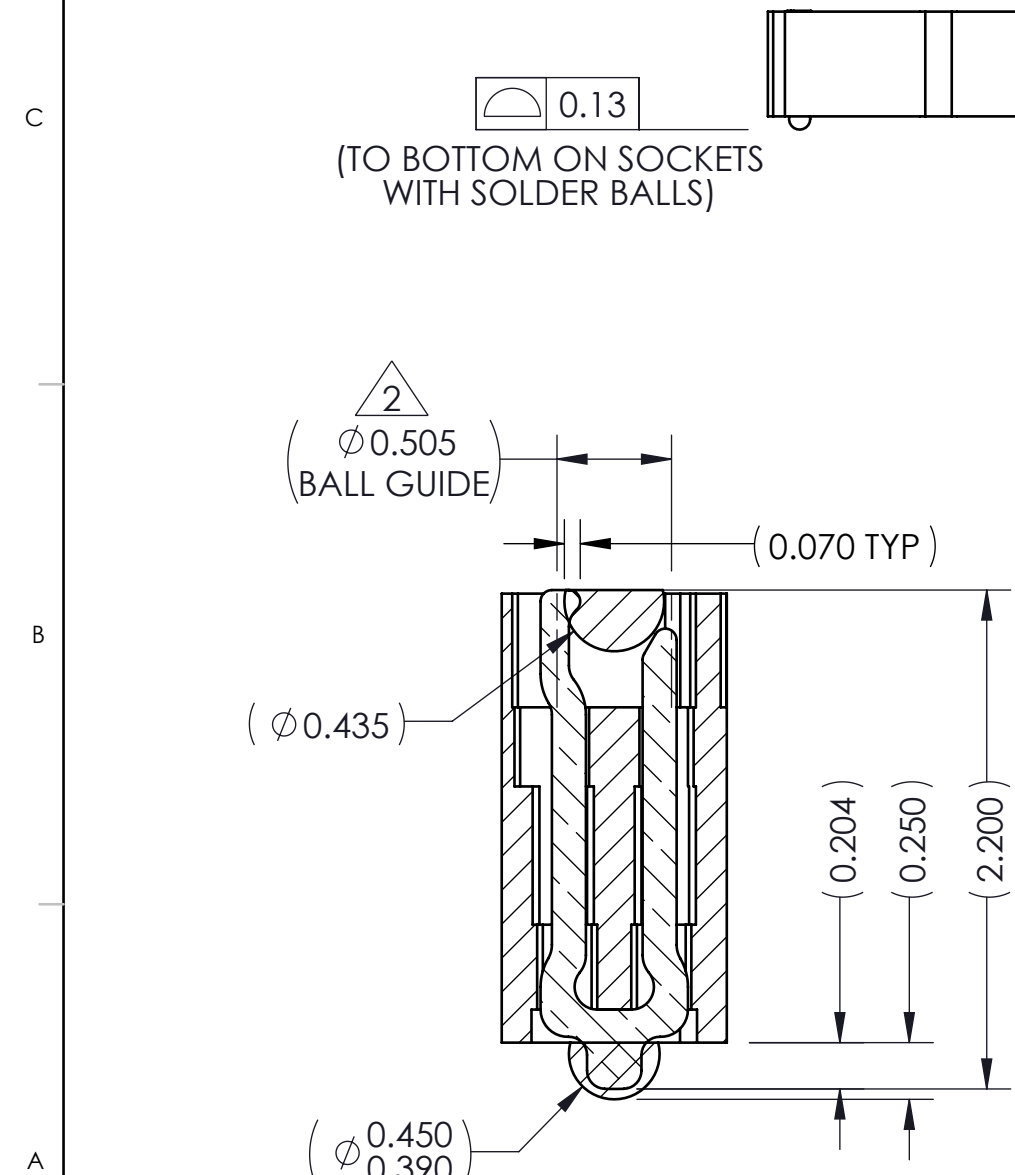
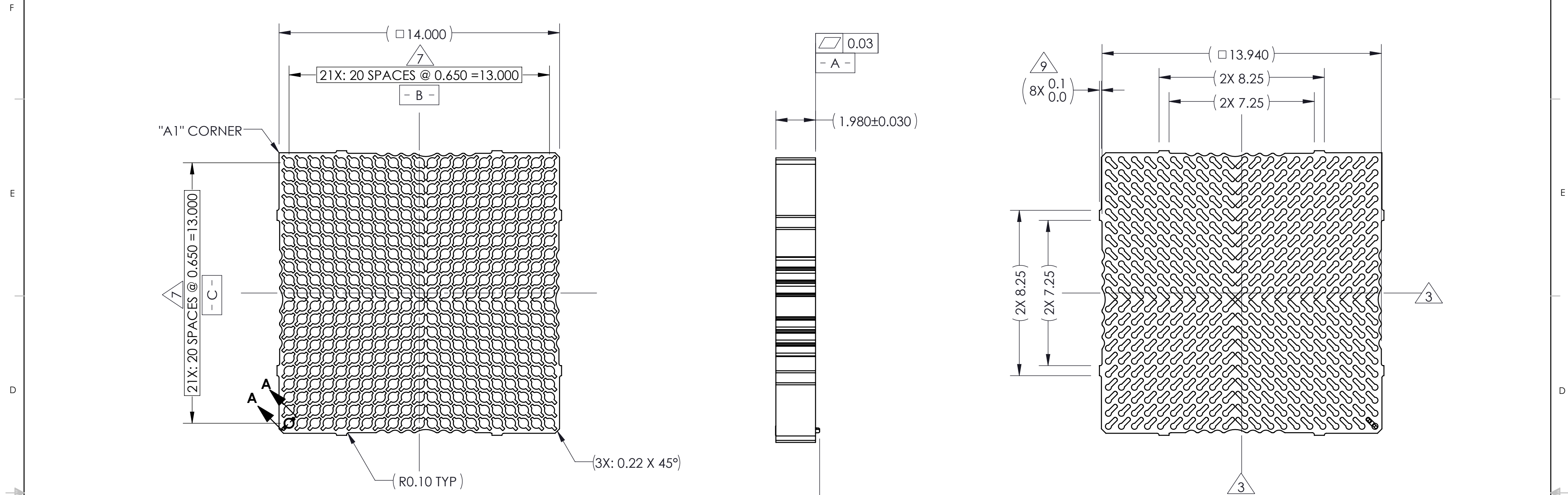

**SECTION A-A**  
SCALE 30:1

PART NUMBER	DESCRIPTION
GR1030-0001	SCKT, 441G80 14.0-0.65, LIF (EUTECTIC SOLDER BALL)
GR1030-0002	SCKT, 441G80 14.0-0.65, LIF (SAC305 SOLDER BALL)
GR1030-0003	SCKT, 441G80 14.0-0.65, LIF (WITHOUT SOLDER BALL)
103864-0004	PRESS DEVICE INSERT, 14.0 X 14.0, W/POCKET (SOLD SEPARATELY)
104553-0558	STENCIL, FLEX, 441BGA 14.0-0.65 (SOLD SEPARATELY)
108639-0138	ALIGNMENT FRAME, 14.0X14.0 (SOLD SEPARATELY)
105900-0004	EXTRACTION TOOL, 4 X 53 (SOLD SEPARATELY)

**NOTES:**

- UNLESS OTHERWISE NOTED, ALL FEATURES LOCATED  $\oplus 0.10$  A B C
- DATUM'S - B - AND - C - ARE DETERMINED BY  $\varnothing 0.505$  FEATURES ON CORNER SLOTS.
- CENTER OF CONTACT PATTERN.
- REFERENCE IRONWOOD ELECTRONICS SPECIFICATION 700001-0001 FOR SOLDER ATTACHMENT.
- REFERENCE IRONWOOD ELECTRONICS SPECIFICATION 700001-0002 FOR APPLICATION NOTES.
- DIMENSION LOCATES CENTER OF CONTACT/SLOT.
- ALL CONTACTS/SOLDER BALLS ARE NOT SHOWN TO MINIMIZE FILE SIZE.
- TOOLING MARKS PERMITTED. MAXIMUM 0.100 PROTRUSION SHOWN.

<p><b>PROPRIETARY AND CONFIDENTIAL</b> THE INFORMATION CONTAINED IN THIS DRAWING IS THE SOLE PROPERTY OF IRONWOOD ELECTRONICS, INC. ANY REPRODUCTION IN PART OR AS A WHOLE WITHOUT THE WRITTEN PERMISSION OF IRONWOOD ELECTRONICS, INC IS PROHIBITED.</p>	UNLESS OTHERWISE SPECIFIED:	NAME	DATE	<b>IRONWOOD ELECTRONICS, INC.</b> 1335 EAGANDALE COURT EAGAN, MINNESOTA 55121 952-229-8200	
	DIMENSIONS ARE IN MILLIMETERS	DRAWN	DJP		3/23/20
	TOLERANCES: ANGULAR: $\pm 1^\circ$ X.X $\pm 0.25$ X.XX $\pm 0.10$ X.XXX $\pm 0.050$	CHECKED	JJB	3/24/20	TITLE: <b>SCKT, 441G80 14.0-0.65, LIF</b>
	INTERPRET GEOMETRIC TOLERANCING PER:	LEGEND:		DWG. NO.	
MATERIAL	SEE B.O.M	$\triangle$	NOTE CALLOUT	REV	
FINISH		$\square$	REVISION CHANGE	<b>GR1030-XXXX</b>	
DO NOT SCALE DRAWING		$\circ$	ITEM NUMBER	A	
				SCALE: 7:1	
				SIZE: C	
				SHEET 1 OF 2	

**SOCKET FOR DEVICES THAT ARE WITHIN THESE SPECIFICATIONS**

Lead Count	<b>N</b>	441	Package Size	<b>D</b>	14.00
Columns	<b>ND</b>	21		<b>E</b>	14.00
Rows	<b>NE</b>	21	Ball Spacing	<b>D1</b>	13.00
Pitch	<b>e</b>	0.650		<b>E1</b>	13.00
Ball Size	<b>b</b>	0.435 ± 0.05	Encapsulant/ Top Size	<b>D2</b>	N/A
Total Thickness	<b>A</b>	N/A		<b>E2</b>	N/A
Ball Height	<b>A1</b>	0.26 MIN	Pattern Style	FULL ARRAY	
Substrate Thickness	<b>A2</b>	N/A	Perimeter Rows	N/A	
Top Thickness	<b>A3</b>	N/A	Center Array	N/A	

**Form Tolerances**

Edge	<b>aaa</b>	N/A	Bottom	<b>ddd</b>	N/A
Substrate	<b>bbb</b>	N/A	Position	<b>eee</b>	N/A
Top	<b>ccc</b>	N/A	Position	<b>fff</b>	N/A

\* ALL DIMENSIONS ARE IN MILLIMETERS.

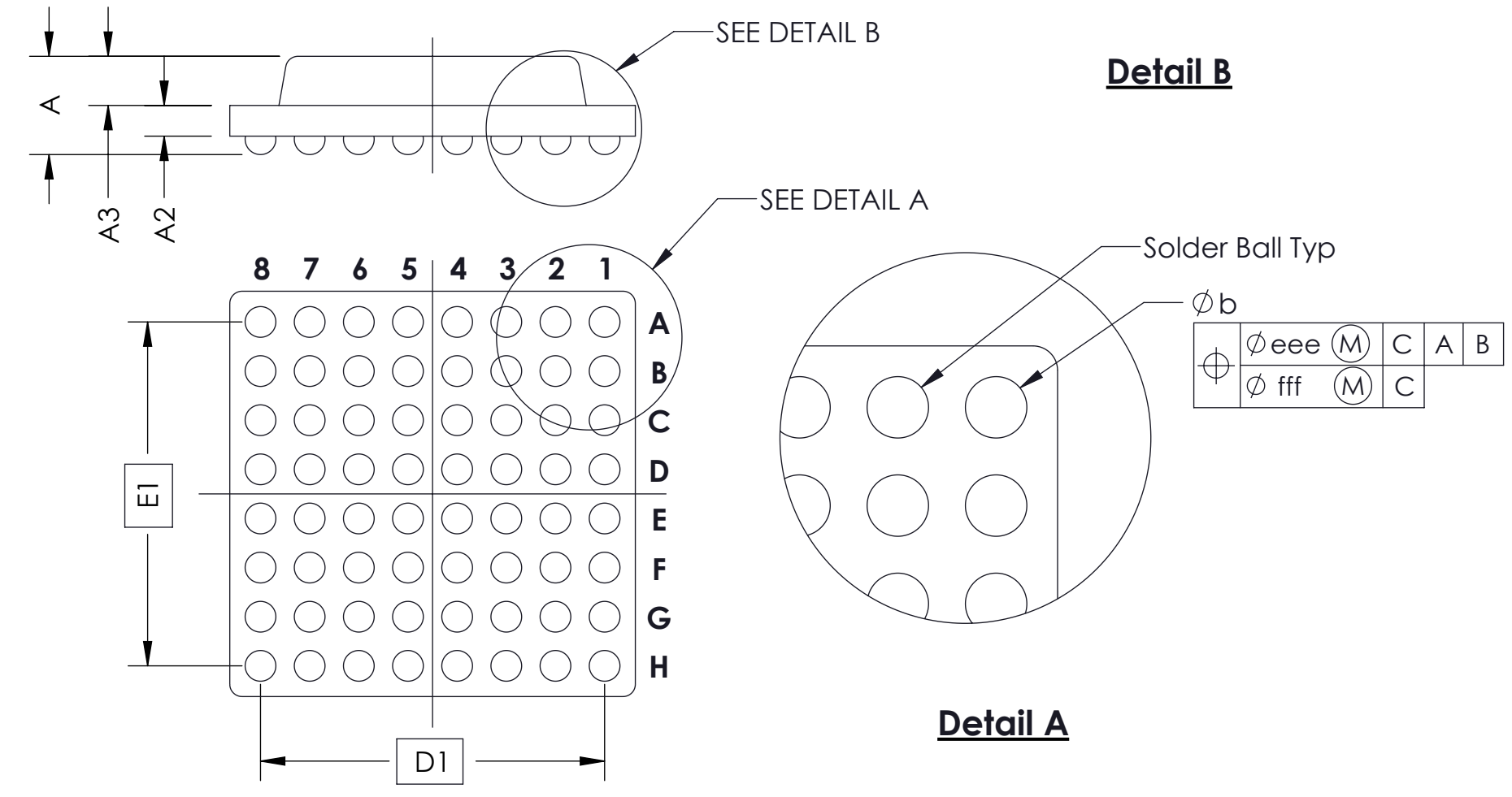
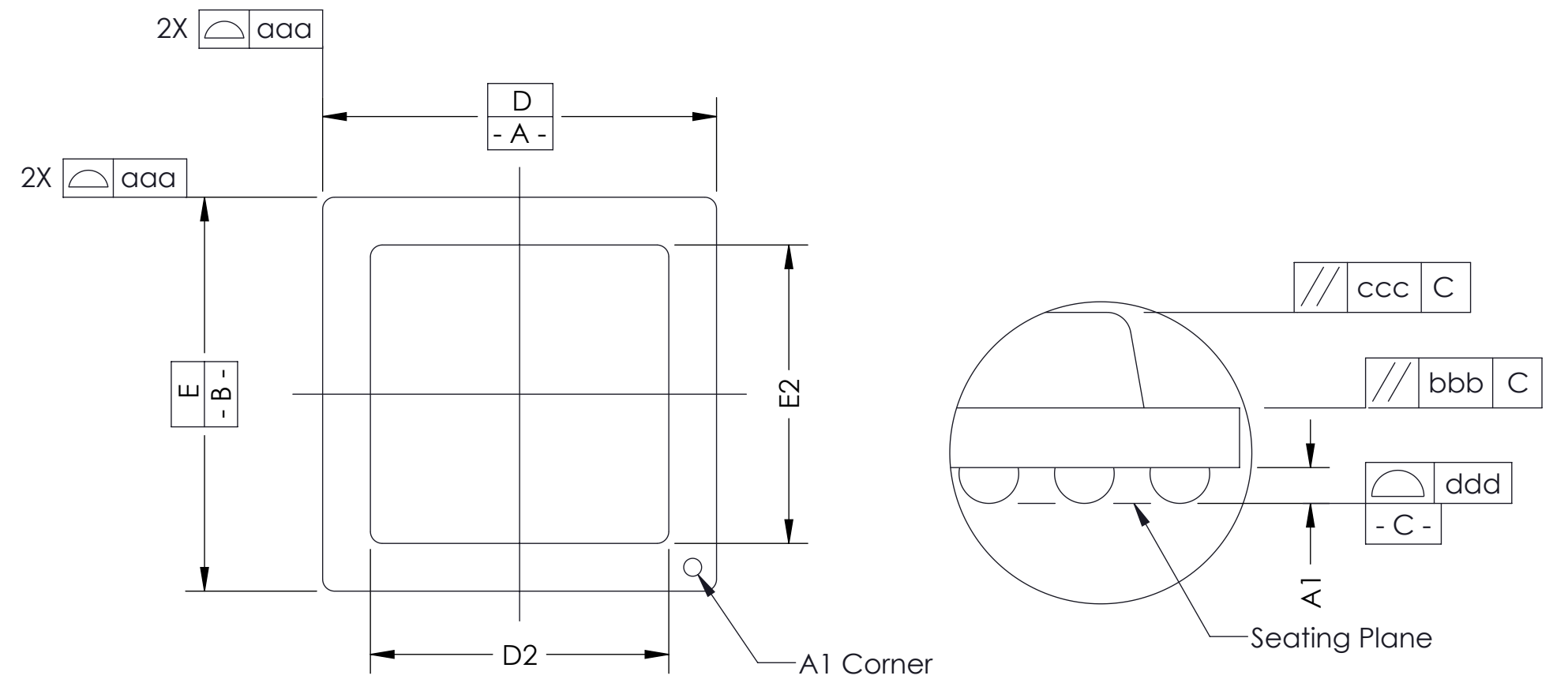
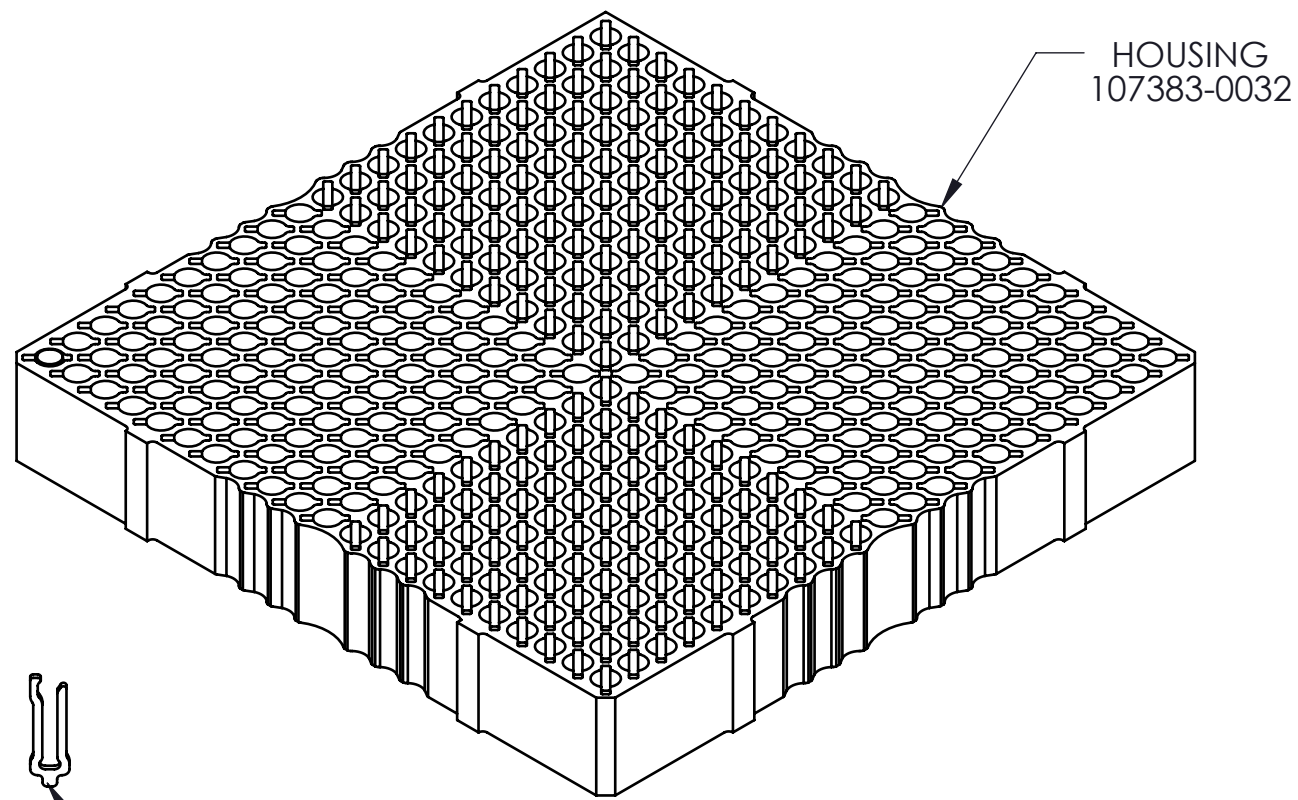

**Generic Representation with Full Grid Array**

<p><b>PROPRIETARY AND CONFIDENTIAL</b></p> <p>THE INFORMATION CONTAINED IN THIS DRAWING IS THE SOLE PROPERTY OF IRONWOOD ELECTRONICS, INC. ANY REPRODUCTION IN PART OR AS A WHOLE WITHOUT THE WRITTEN PERMISSION OF IRONWOOD ELECTRONICS, INC IS PROHIBITED.</p>	UNLESS OTHERWISE SPECIFIED:	NAME	DATE	<b>IRONWOOD ELECTRONICS, INC.</b> 1335 EAGANDALE COURT EAGAN, MINNESOTA 55121 952-229-8200	
	DIMENSIONS ARE IN MILLIMETERS	DRAWN	DJP		3/23/20
	TOLERANCES:	CHECKED	JJB	3/24/20	TITLE: <b>SCKT, 441G80</b> <b>14.0-0.65, LIF</b>
	ANGULAR: ± 1°	LEGEND:			
X.X ± 0.25	△ NOTE CALLOUT			DWG. NO.	
X.XX ± 0.10	◻ REVISION CHANGE			REV	
X.XXX ± 0.050	○ ITEM NUMBER			<b>GR1030-XXXX</b> <b>A</b>	
INTERPRET GEOMETRIC TOLERANCING PER:				N/A	
MATERIAL				SIZE: C	
SEE B.O.M				SHEET 2 OF 2	
FINISH					
DO NOT SCALE DRAWING					