

REV	ECO	BY	DESCRIPTION	APV	DATE
A	32106	RS	INITIAL DESIGN	NSJ	10/01/19

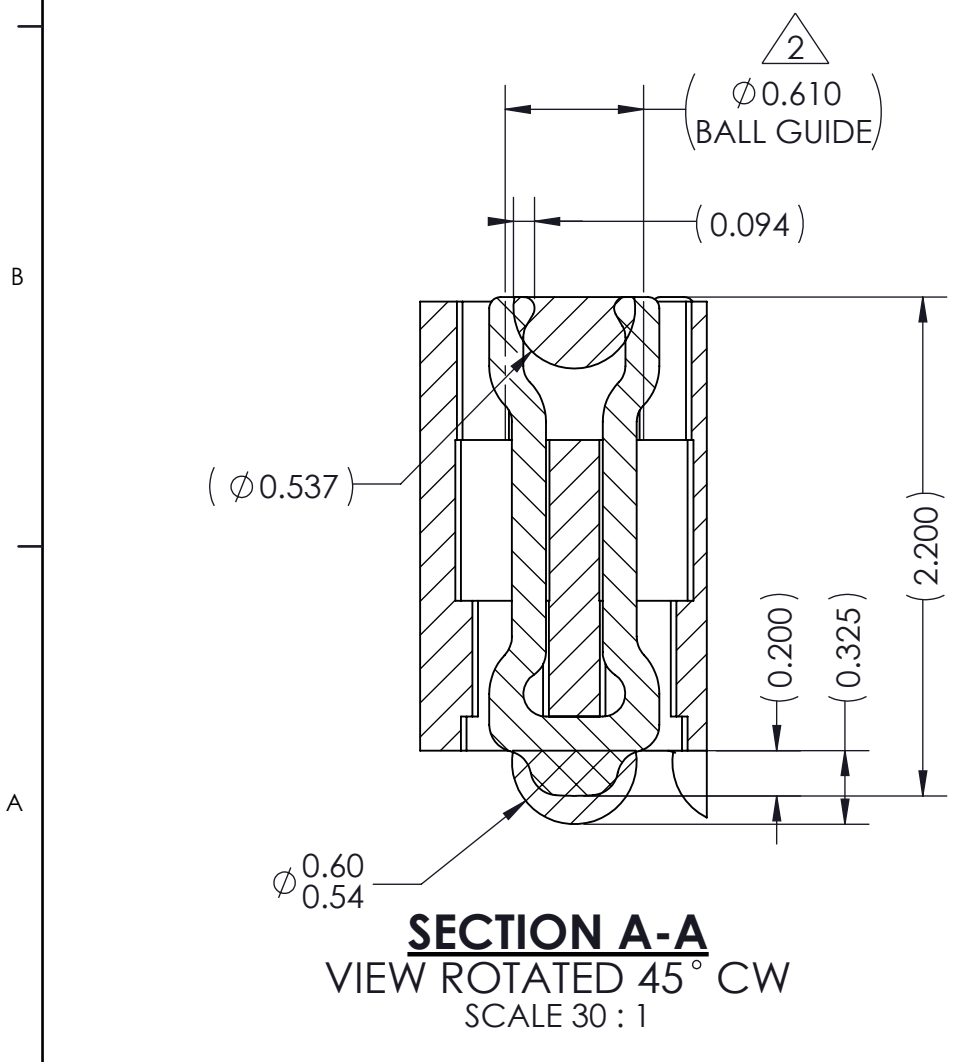
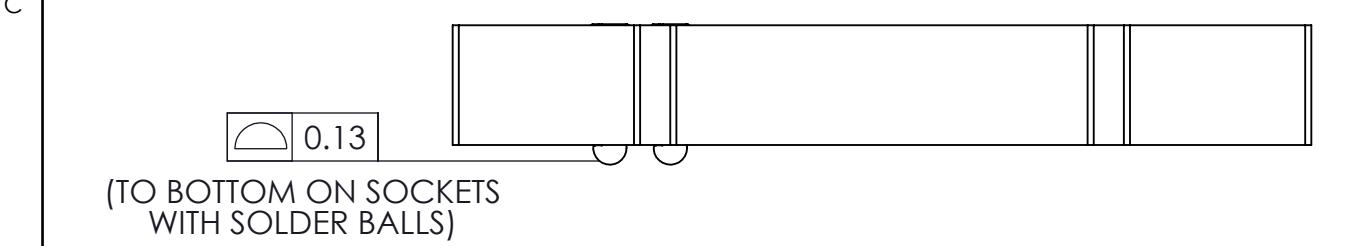
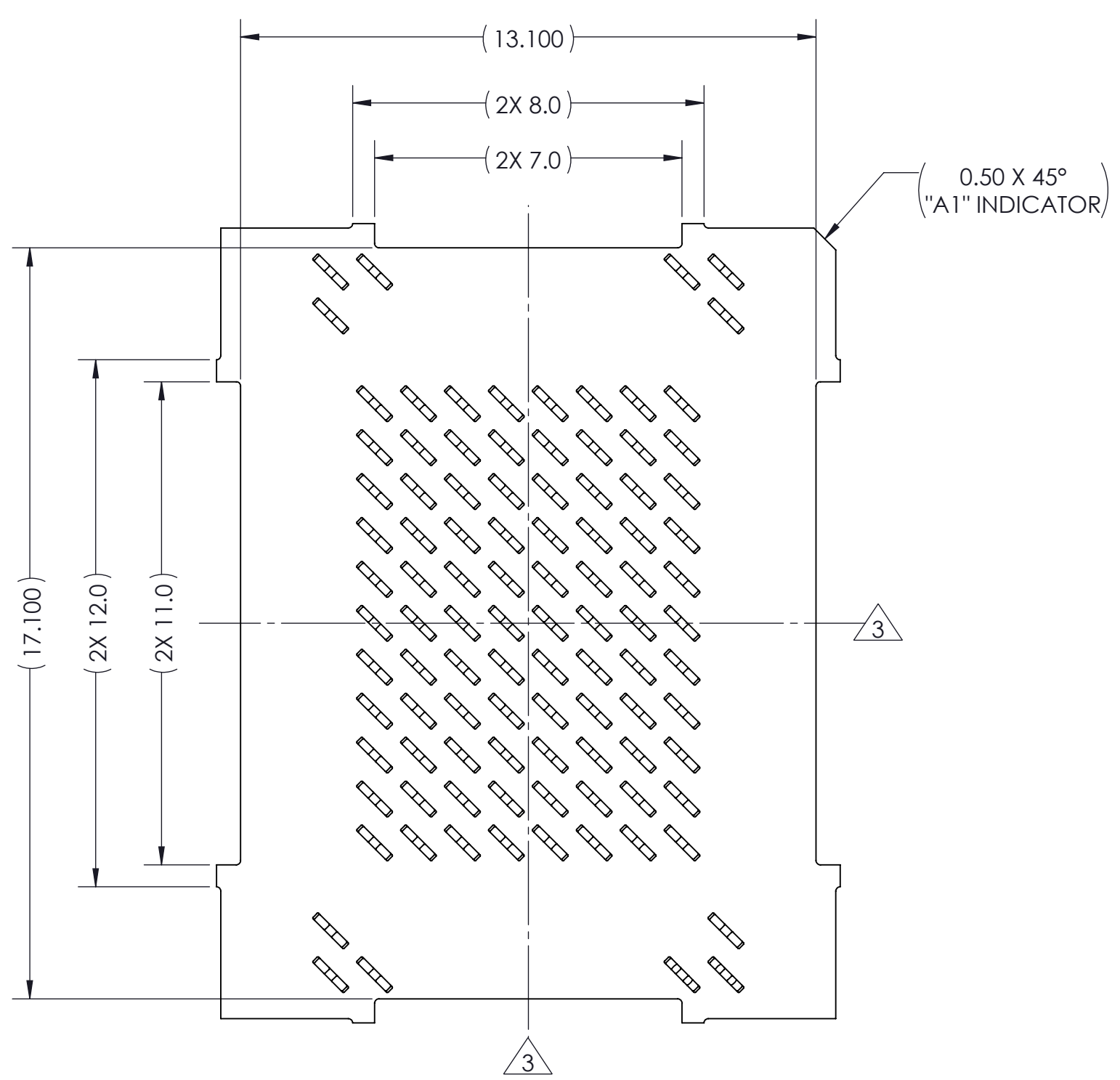
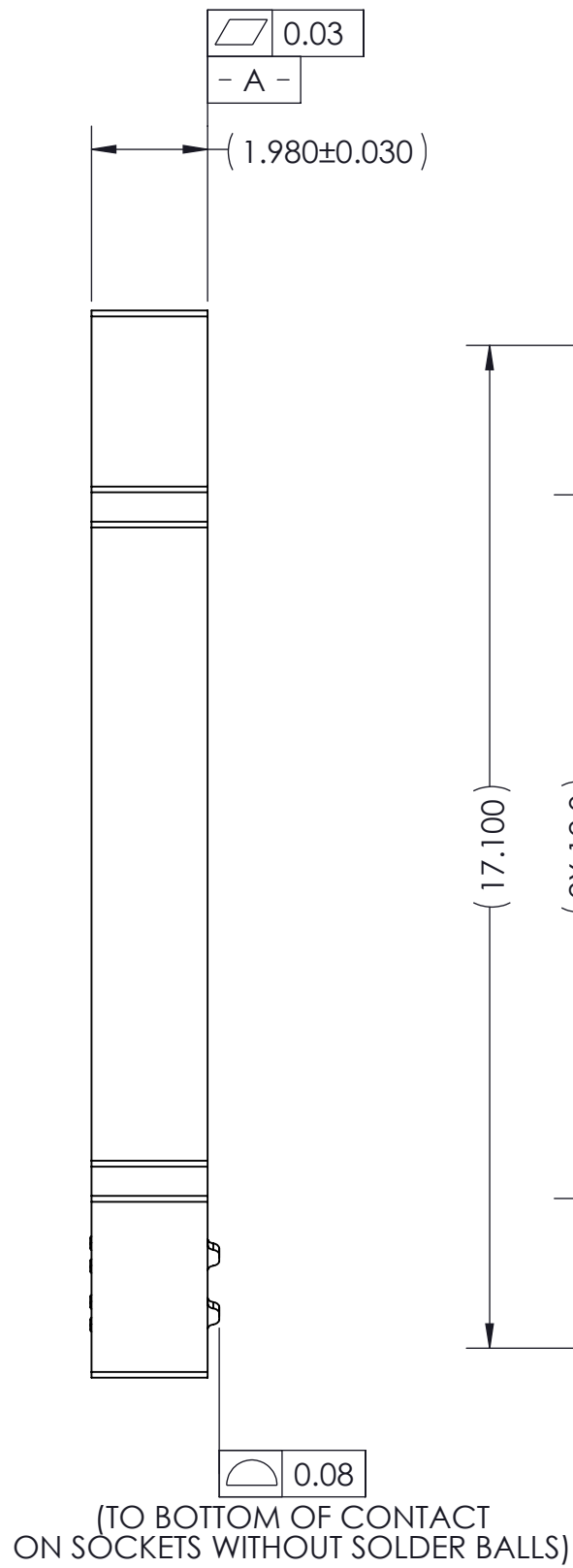
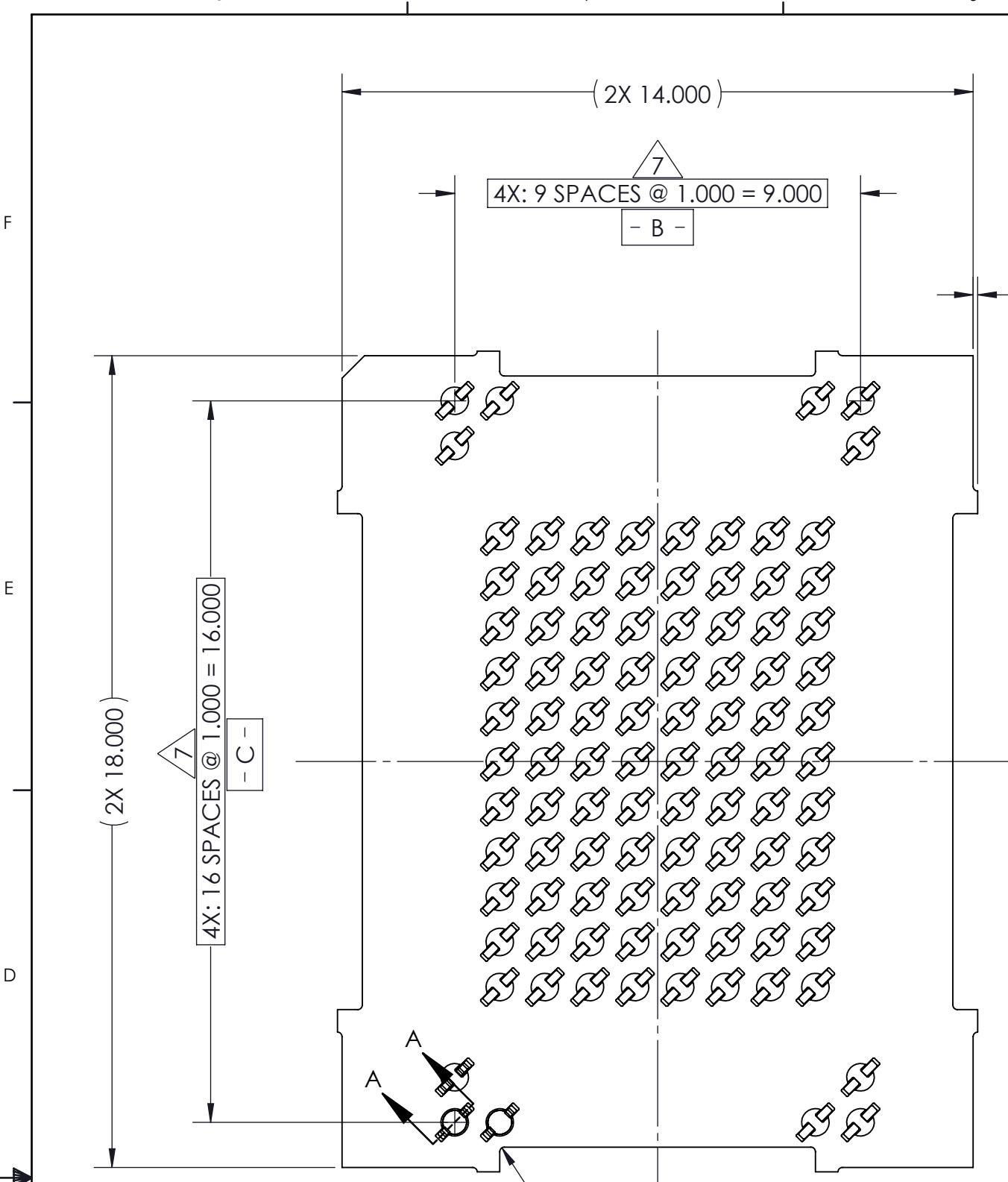

PART NUMBER	DESCRIPTION
111050-0001	SCKT, 100GRY 14.0X18.0-1.0 (EUTECTIC SOLDER BALL)
111050-0002	SCKT, 100GRY 14.0X18.0-1.0 (SAC305 SOLDER BALL)
111050-0003	SCKT, 100GRY 14.0X18.0-1.0 (WITHOUT SOLDER BALL)
103864-0116	PRESS DEVICE INSERT, 14.0 X 18.0 (SOLD SEPARATELY)
104553-0533	STENCIL, FLEX, 100BGA 14.0X18.0-1.0 (SOLD SEPARATELY)
105900-0004	EXTRACTION TOOL, 4 X 53 (SOLD SEPARATELY)

NOTES:

- UNLESS OTHERWISE NOTED, ALL FEATURES LOCATED $\oplus 0.10$ A B C
- DATUM'S - B - AND - C - ARE DETERMINED BY $\phi 0.600$ FEATURES ON CORNER SLOTS.
- CENTER OF CONTACT PATTERN.
- REFERENCE HSEO TECHNOLOGIES SPECIFICATION 700001-0001 FOR SOLDER ATTACHMENT.
- REFERENCE HSEO TECHNOLOGIES SPECIFICATION 700001-0002 FOR APPLICATION NOTES.
- DIMENSION LOCATES CENTER OF CONTACT/SLOT.
- TOOLING MARKS PERMITTED. MAXIMUM 0.10 PROTRUSION SHOWN.
- ALL CONTACTS/SOLDER BALLS ARE NOT SHOWN TO MINIMIZE FILE SIZE.

<p>HSIO technologies PROPRIETARY AND CONFIDENTIAL</p> <p>THE INFORMATION CONTAINED IN THIS DRAWING IS THE SOLE PROPERTY OF HSEO TECHNOLOGIES, LLC. ANY REPRODUCTION IN PART OR AS A WHOLE WITHOUT THE WRITTEN PERMISSION OF HSEO TECHNOLOGIES, LLC IS PROHIBITED.</p>	UNLESS OTHERWISE SPECIFIED:	NAME	DATE	HSEO TECHNOLOGIES, LLC. 13400 68th AVENUE NORTH MAPLE GROVE, MINNESOTA 55311 763-447-6260	
	DIMENSIONS ARE IN MILLIMETERS TOLERANCES: ANGULAR: $\pm 1^\circ$ X.X ± 0.25 X.XX ± 0.10 X.XXX ± 0.050	DRAWN	RS		10/01/19
	INTERPRET GEOMETRIC TOLERANCING PER:	CHECKED	NSJ		10/01/19
	MATERIAL SEE B.O.M	LEGEND:			TITLE:
FINISH	DO NOT SCALE DRAWING	△ NOTE CALLOUT	◇ REVISION CHANGE	○ ITEM NUMBER	
				SCKT, 100GRY 14.0X18.0-1.0 DWG. NO. 111050-XXXX REV A	
		SCALE: 8:1	SIZE: C	SHEET 1 OF 2	

SOCKET FOR DEVICES THAT ARE WITHIN THESE SPECIFICATIONS

Lead Count	N	100	Package Size	D	14.00
Columns	ND	10		E	18.00
Rows	NE	17	Ball Spacing	D1	9.000
Pitch	e	1.000		E1	16.000
Ball Size	b	0.50±0.05	Encapsulant/ Top Size	D2	N/A
Total Thickness	A	N/A		E2	N/A
Ball Height	A1	0.30 MIN	Pattern Style	IRREGULAR	
Substrate Thickness	A2	N/A	Perimeter Rows	N/A	
Top Thickness	A3		Center Array	N/A	

Form Tolerances

Edge	aaa	N/A	Bottom	ddd	N/A
Substrate	bbb	N/A	Position	eee	N/A
Top	ccc	N/A	Position	fff	N/A

* ALL DIMENSIONS ARE IN MILLIMETERS.

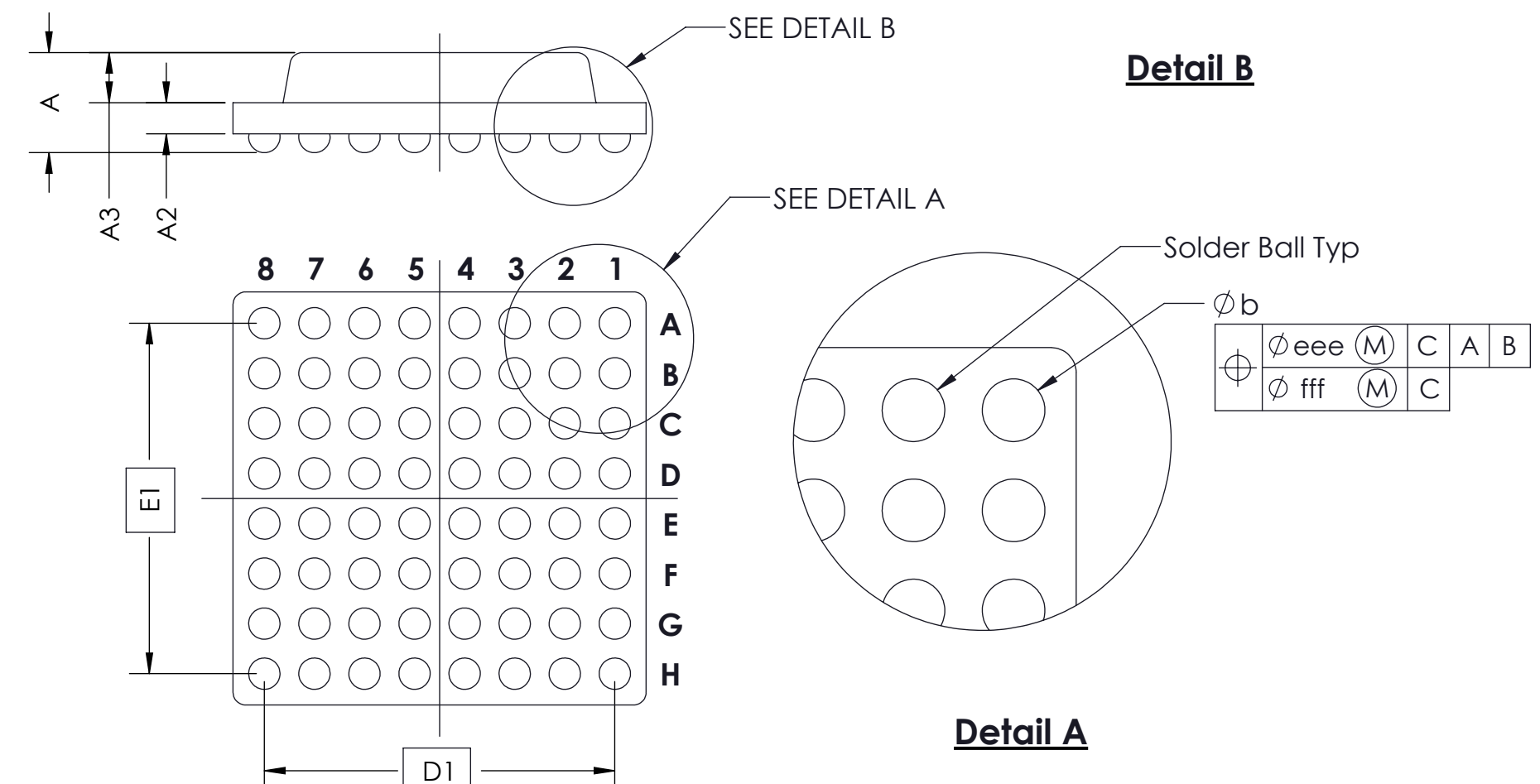
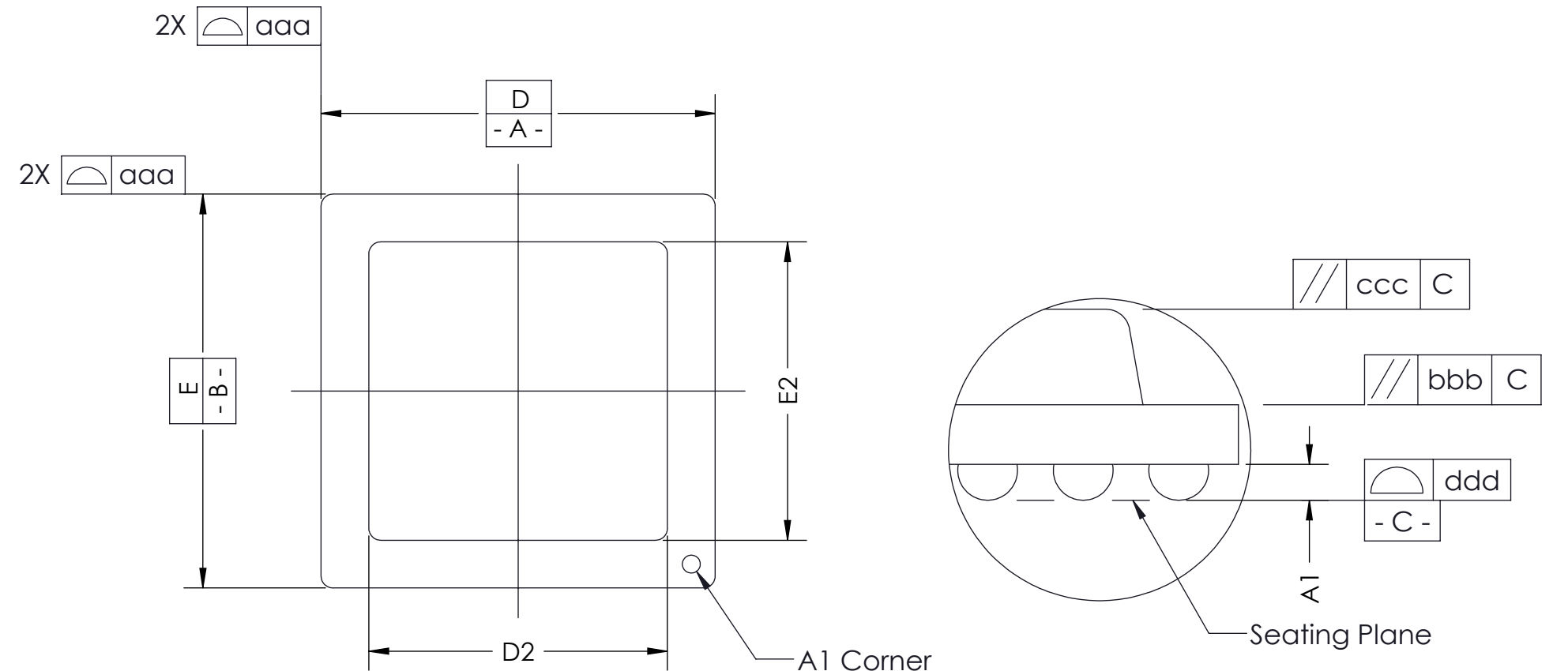
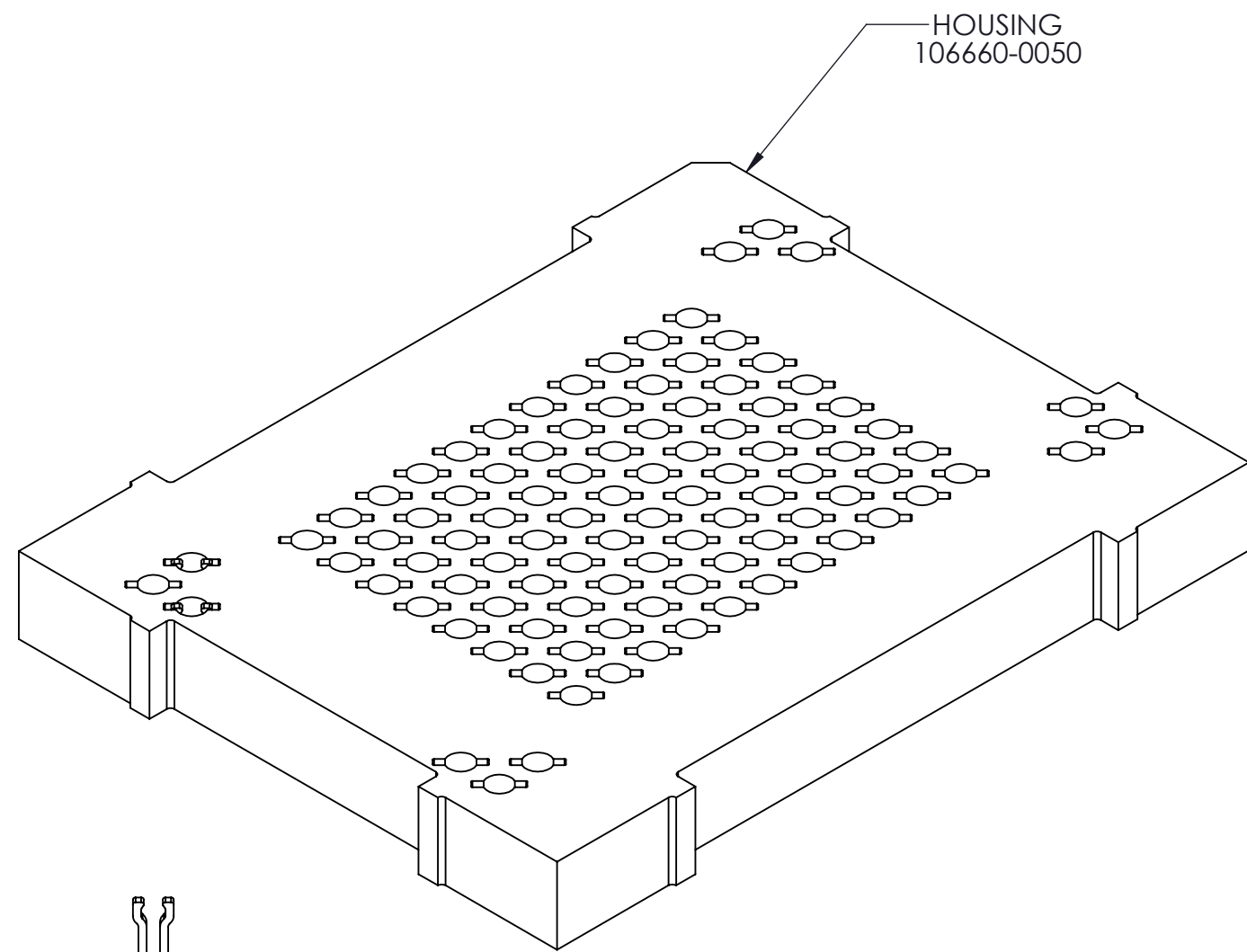

Generic Representation with Full Grid Array

<p>HSIO technologies PROPRIETARY AND CONFIDENTIAL</p> <p>THE INFORMATION CONTAINED IN THIS DRAWING IS THE SOLE PROPERTY OF HSIO TECHNOLOGIES, LLC. ANY REPRODUCTION IN PART OR AS A WHOLE WITHOUT THE WRITTEN PERMISSION OF HSIO TECHNOLOGIES, LLC IS PROHIBITED.</p>	UNLESS OTHERWISE SPECIFIED: DIMENSIONS ARE IN MILLIMETERS TOLERANCES: ANGULAR: ± 1° X.X ±0.25 X.XX ±0.10 X.XXX ±0.050	DRAWN RS 10/01/19	NAME RS	DATE 10/01/19	<p>HSIO TECHNOLOGIES, LLC. 13400 68th AVENUE NORTH MAPLE GROVE, MINNESOTA 55311 763-447-6260</p> <p>TITLE: SCKT, 100GRY 14.0X18.0-1.0</p> <p>DWG. NO. 111050-XXXX</p> <p>SCALE: 8:1 SIZE: C SHEET 2 OF 2</p>
	INTERPRET GEOMETRIC TOLERANCING PER:	CHECKED NSJ 10/01/19	LEGEND:	REV A	
	MATERIAL SEE B.O.M		△ NOTE CALLOUT		
	FINISH		◻ REVISION CHANGE		
DO NOT SCALE DRAWING		○ ITEM NUMBER			