

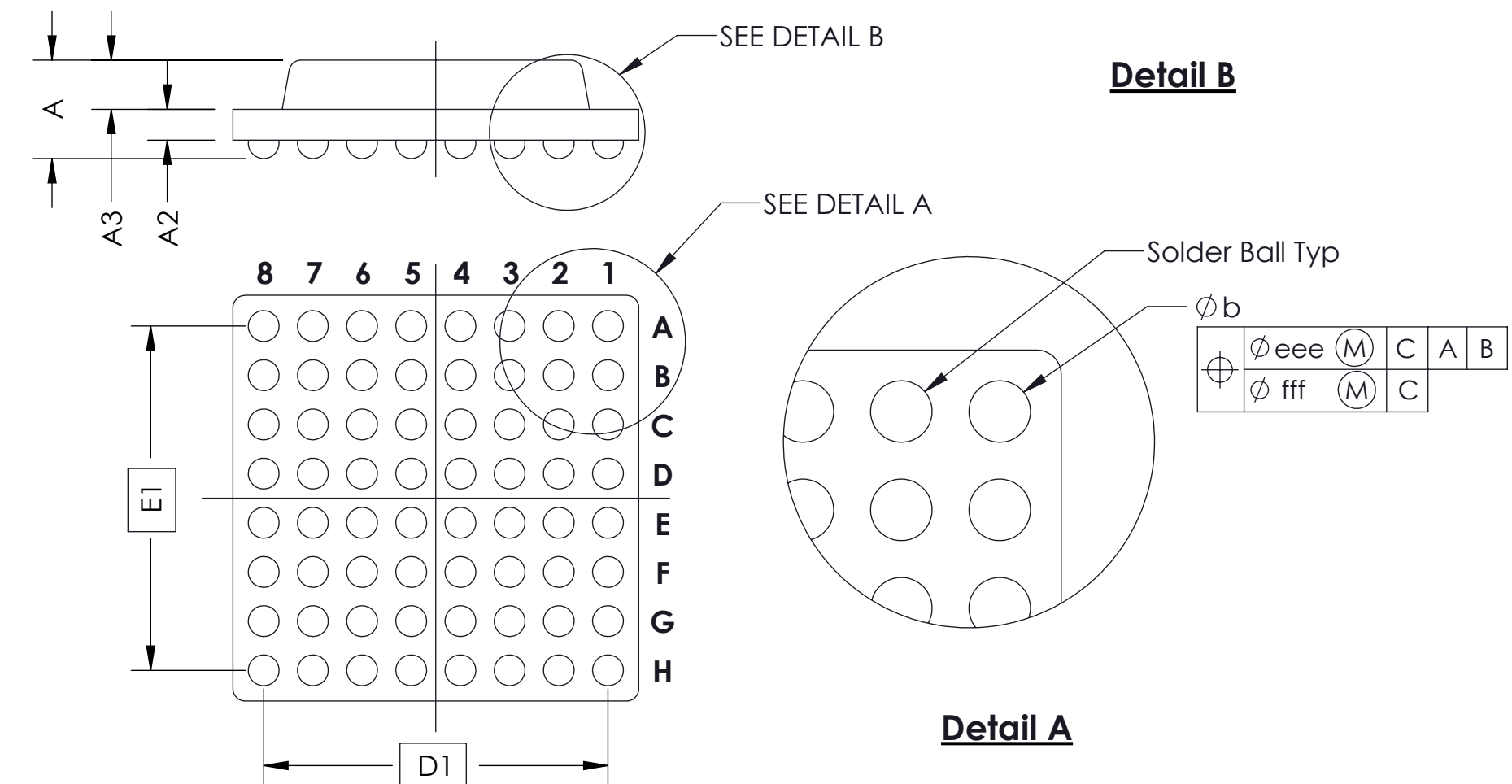

SOCKET FOR DEVICES THAT ARE WITHIN THESE SPECIFICATIONS					
Lead Count	<b>N</b>	376	Package Size	<b>D</b>	14.00
Columns	<b>ND</b>	34		<b>E</b>	14.00
Rows	<b>NE</b>	34	Ball Spacing	<b>D1</b>	13.200
Pitch	<b>e</b>	0.40		<b>E1</b>	13.200
Ball Size	<b>b</b>	0.25±0.05	Encapsulant/ Top Size	<b>D2</b>	N/A
Total Thickness	<b>A</b>	0.59±0.07		<b>E2</b>	N/A
Ball Height	<b>A1</b>	0.175 MIN	Pattern Style	IRREGULAR	
Substrate Thickness	<b>A2</b>	N/A	Perimeter Rows	N/A	
Top Thickness	<b>A3</b>		Center Array	N/A	
Form Tolerances					
Edge	<b>aaa</b>	N/A	Bottom	<b>ddd</b>	N/A
Substrate	<b>bbb</b>	N/A	Position	<b>eee</b>	N/A
top	<b>ccc</b>	N/A	Position	<b>fff</b>	N/A

ALL DIMENSIONS IN MILLIMETERS.

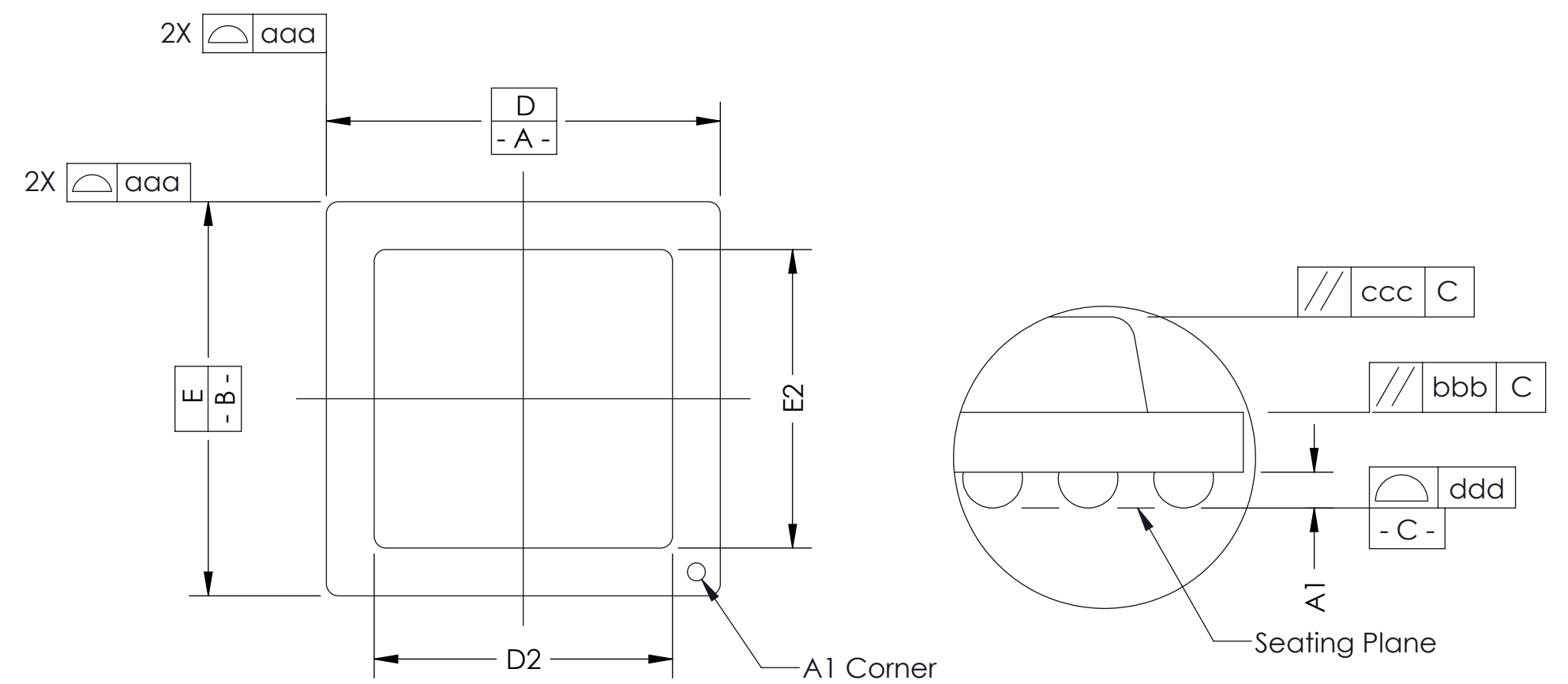
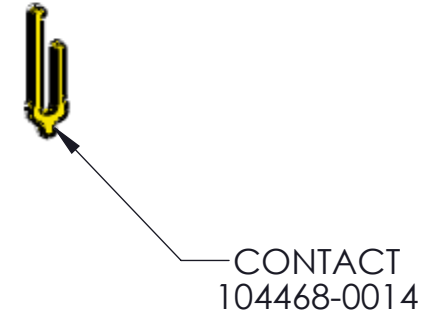
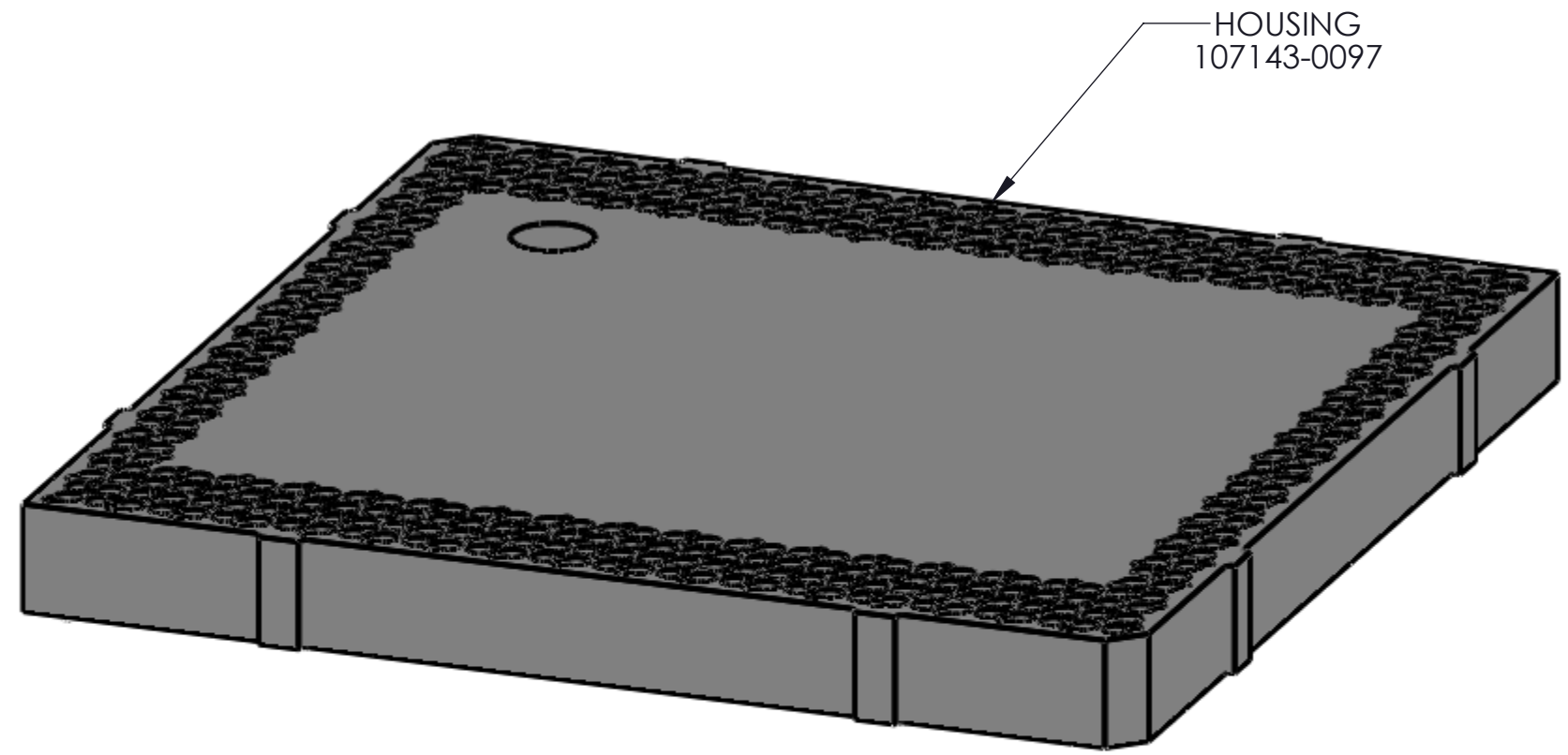

**Generic Representation with Full Grid Array**

<p><b>HSIO technologies</b> PROPRIETARY AND CONFIDENTIAL</p> <p>THE INFORMATION CONTAINED IN THIS DRAWING IS THE SOLE PROPERTY OF HSIO TECHNOLOGIES, LLC. ANY REPRODUCTION IN PART OR AS A WHOLE WITHOUT THE WRITTEN PERMISSION OF HSIO TECHNOLOGIES, LLC IS PROHIBITED.</p>	UNLESS OTHERWISE SPECIFIED: DIMENSIONS ARE IN MILLIMETERS TOLERANCES: ANGULAR: ± 1° X.X ±0.25 X.XX ±0.10 X.XXX ±0.050	DRAWN PAR 05/16/16	NAME PAR	DATE 05/16/16	<b>HSIO TECHNOLOGIES, LLC.</b> <b>13400 68th AVENUE NORTH</b> <b>MAPLE GROVE, MINNESOTA 55311</b> <b>763-447-6260</b>	
	INTERPRET GEOMETRIC TOLERANCING PER:	CHECKED NSJ 05/16/16	LEGEND: △ NOTE CALLOUT □ REVISION CHANGE ○ ITEM NUMBER			TITLE: SCKT, 376G40 14.0-0.40 P.O.P.
	MATERIAL SEE BOM	FINISH	DO NOT SCALE DRAWING		DWG. NO. <b>109071-XXXX</b>	REV <b>A</b>
					SCALE: 10:1	SIZE: C