

REV	ECO	BY	DESCRIPTION	APV	DATE
A	30816	SK	Initial Design	KW	06/17/11

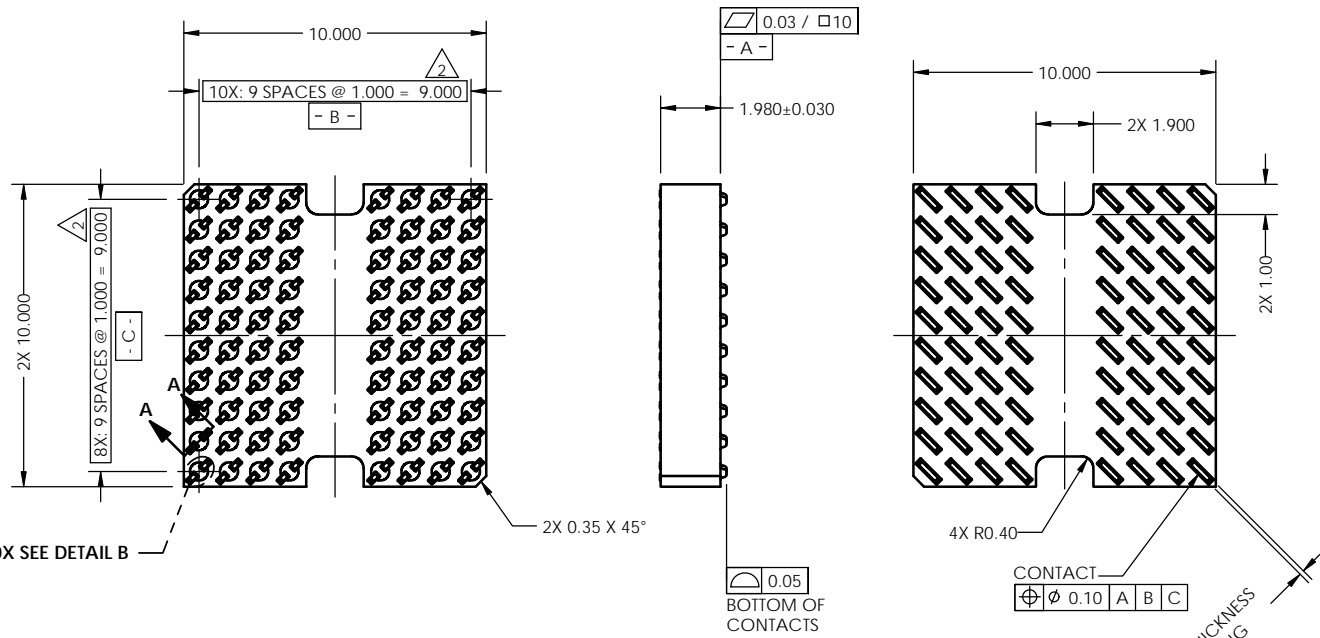

- Notes:
- Footprint part number is 104311-0282.
  - Locates center of contact slots.
  - Press size 10.00 x 10.00.
  - Datums **- B -** and **- C -** are determined by  $\phi 0.600$  opening in corner slots.
  - Unless otherwise specified, all features located  $\oplus \phi 0.10$  A B C

80X SEE DETAIL B

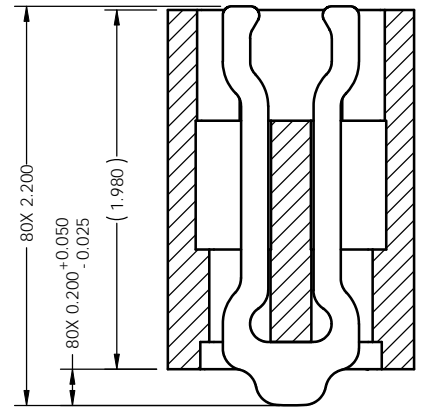

SECTION A-A  
Scale 4:1

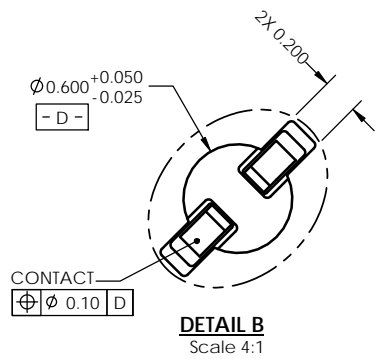

DETAIL B  
Scale 4:1

PARTS LIST	
PART NUMBER	DESCRIPTION
104670-0031	SCKT, 80GRY10-1.00
104671-0031	CS, 80GRY10-1.00
103864-0033	PRESS, DEV INS, 10 X 10 (SOLD SEPARATELY)
104553-0215	STEN FLEX, 80GRY10-1.00 (SOLD SEPARATELY)

UNLESS OTHERWISE SPECIFIED DIMENSIONS ARE IN MILLIMETERS DIM'S APPLY AFTER PLATING TOLERANCES UNLESS OTHERWISE NOTED:		THE INFORMATION CONTAINED IN THIS DRAWING IS THE SOLE PROPERTY OF CASCADE MICROTECH, INC. ANY REPRODUCTION IN PART OR WHOLE WITHOUT THE WRITTEN PERMISSION OF CASCADE MICROTECH, INC. IS PROHIBITED.											
ANGLES ±1°		7115 NORTHLAND TERRACE SUITE 400 BROOKLYN PARK, MN 55428 (763) 509-0066											
DECIMALS XX ±0.25 XXX ±0.10 XXXX ±0.050		<b>DRAWING APPROVALS</b> <table border="1"> <tr> <th>NAME</th> <th>DATE</th> </tr> <tr> <td>S. Klanderud</td> <td>06/17/11</td> </tr> <tr> <th>NAME</th> <th>DATE</th> </tr> <tr> <td>K. Wilson</td> <td>06/17/11</td> </tr> </table>		NAME	DATE	S. Klanderud	06/17/11	NAME	DATE	K. Wilson	06/17/11		
NAME	DATE												
S. Klanderud	06/17/11												
NAME	DATE												
K. Wilson	06/17/11												
LEGEND: NOTE CALLOUT REVISION CHANGE ITEM NUMBER		<b>SCKT, 80GRY10-1.0</b> <table border="1"> <tr> <td>DESIGN: S. Klanderud</td> <td>DATE: 06/17/11</td> </tr> <tr> <td>APPROV: K. Wilson</td> <td>DATE: 06/17/11</td> </tr> <tr> <td>SCALE: C</td> <td>MATERIAL: SOLIDWORKS</td> </tr> <tr> <td>QUANTITY: 1</td> <td>DESCRIPTION: 104670-0031</td> </tr> <tr> <td>SEE BOM</td> <td>SHEET: A</td> </tr> </table>		DESIGN: S. Klanderud	DATE: 06/17/11	APPROV: K. Wilson	DATE: 06/17/11	SCALE: C	MATERIAL: SOLIDWORKS	QUANTITY: 1	DESCRIPTION: 104670-0031	SEE BOM	SHEET: A
DESIGN: S. Klanderud	DATE: 06/17/11												
APPROV: K. Wilson	DATE: 06/17/11												
SCALE: C	MATERIAL: SOLIDWORKS												
QUANTITY: 1	DESCRIPTION: 104670-0031												
SEE BOM	SHEET: A												
THIRD ANGLE PROJECTION		<table border="1"> <tr> <td>SCALE: C</td> <td>MATERIAL: SOLIDWORKS</td> <td>DESCRIPTION: 104670-0031</td> <td>SHEET: A</td> </tr> <tr> <td colspan="2">SEE BOM</td> <td colspan="2">1 of 2</td> </tr> </table>		SCALE: C	MATERIAL: SOLIDWORKS	DESCRIPTION: 104670-0031	SHEET: A	SEE BOM		1 of 2			
SCALE: C	MATERIAL: SOLIDWORKS	DESCRIPTION: 104670-0031	SHEET: A										
SEE BOM		1 of 2											

Device Specification					
Lead Count	N	80	Package Size	D	10.00
Columns	ND	8		E	10.00
Rows	NE	10	Ball Spacing	D1	9.00
Pitch	e	1.000		E1	9.00
Ball Size	b	0.50±0.05	Encapsulant/ Top Size	D2	n/a
Total Thickness	A	n/a		E2	n/a
Ball Height	A1	0.30 min	Pattern Style	IRREGULAR*	
Substrate Thickness	A2	n/a	Perimeter Rows	n/a	
Top Thickness	A3	n/a	Center Array	n/a	
Form Tolerances					
Edge	aaa	0.20	Bottom	ddd	0.15
Substrate	bbb	0.20	Position	eee	0.20
top	ccc	0.20	Position	fff	0.08

All dimensions are in millimeters.  
\*See footprint specification for pattern details.

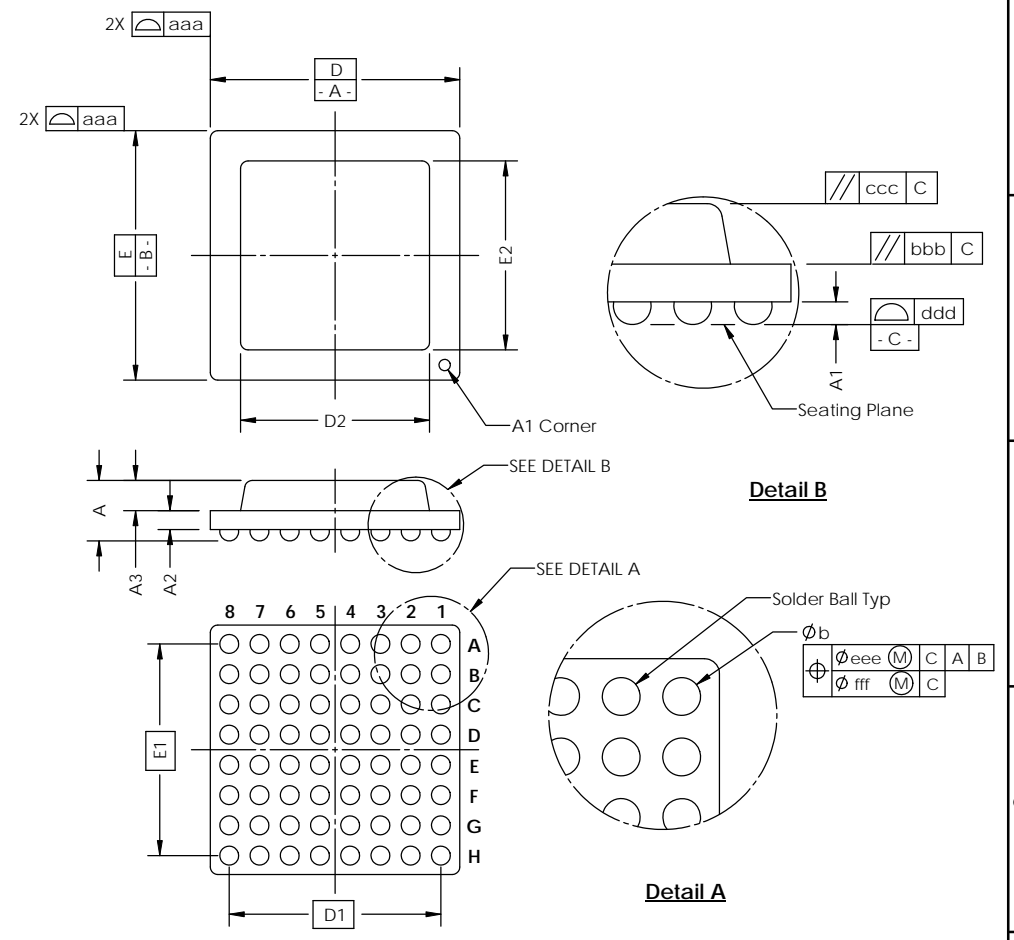
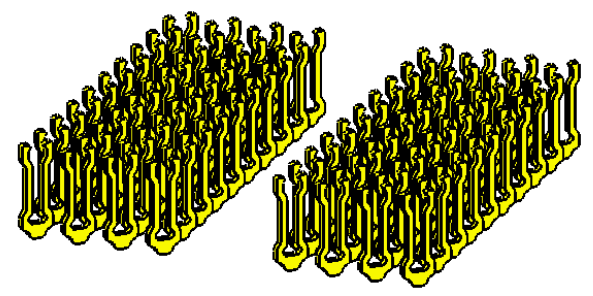
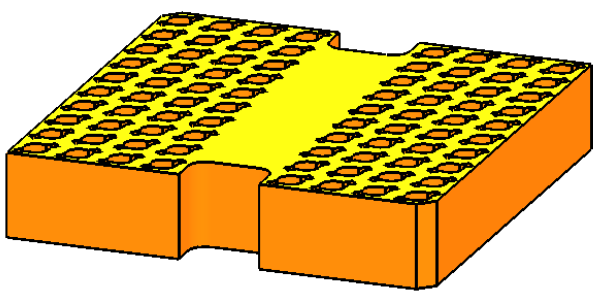

THE INFORMATION CONTAINED IN THIS DRAWING IS THE SOLE PROPERTY OF CASCADE MICROTECH, INC.  
ANY REPRODUCTION IN PART OR WHOLE WITHOUT THE WRITTEN PERMISSION OF CASCADE MICROTECH, INC. IS PROHIBITED.

UNLESS OTHERWISE SPECIFIED  
- DIMENSIONS ARE IN MILLIMETERS  
- DIMES APPLY AFTER PLATING  
TOLERANCES UNLESS OTHERWISE NOTED: DECIMALS  
ANGLES X.X ±0.25  
X.XX ±0.10  
X.XXX ±0.050

LEGEND:  
 NOTE CALLOUT  
 REVISION CHANGE  
 ITEM NUMBER

CASCADE MICROTECH, INC.  
7115 NORTHLAND TERRACE SUITE 400  
BROOKLYN PARK, MN 55428  
(763) 509-0066

**SCKT, 80GRY10-1.0**

SCALE: C CAD FORNAT: SOLIDWORKS DRAWING NO: 104670-0031 REV: A  
 SEE PAGE 1 OF 2