

REV	ECO	BY	DESCRIPTION	APV	DATE
A	30748	SK	Initial Design	AS	03/25/11

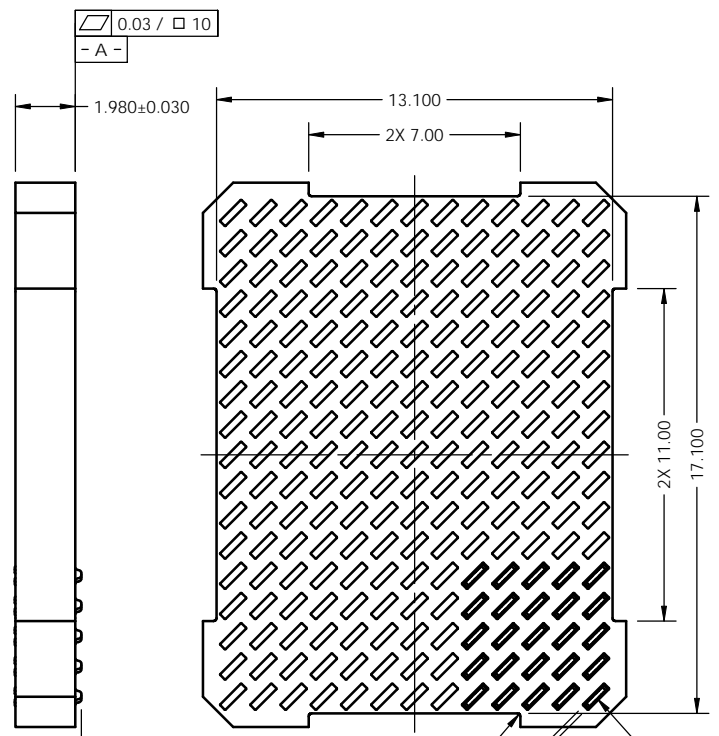
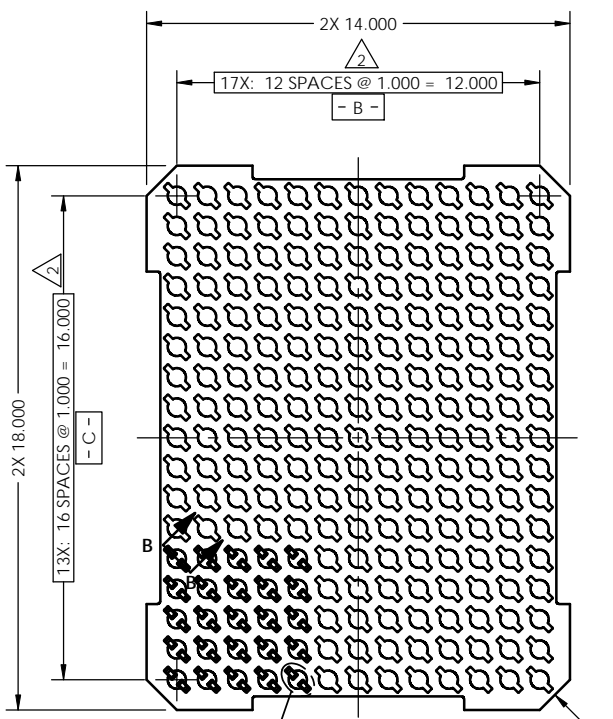

Notes:

1. Break edges 0.05-0.15.
2. Unless otherwise noted, all features located $\oplus \phi 0.10$ A B C
3. Permanently mark part number and rev. level in area shown. Characters to be 1.5 high.
4. Permanently mark company Logo in area shown. Characters to be 4.0 high.

221X SEE DETAIL A

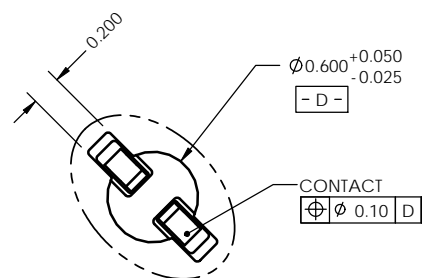

DETAIL A
SCALE 5:1

0.05
BOTTOM OF CONTACTS

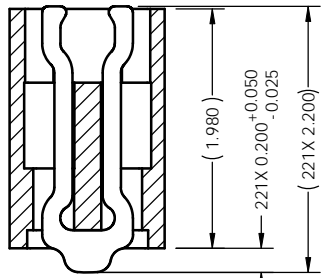

SECTION B-B
SCALE 4:1

CONTACT
 $\oplus \phi 0.10$ A B C

CONTACT THICKNESS WITH PLATING (0.163)

PARTS LIST	
PART NUMBER	DESCRIPTION
104670-0029	SCKT, 221GRY14X18-1.00
104671-0029	CS, 221GRY14X18-1.00
103864-0116	PRESS, DEV INS, 14 X 18 (SOLD SEPARATELY)
104553-0207	STEN FLEX, 221GRY14X18-1.00 (SOLD SEPARATELY)

UNLESS OTHERWISE SPECIFIED DIMENSIONS ARE IN MILLIMETERS DIM'S APPLY AFTER PLATING TOLERANCES UNLESS OTHERWISE NOTED:		THE INFORMATION CONTAINED IN THIS DRAWING IS THE SOLE PROPERTY OF CASCADE MICROTECH, INC. ANY REPRODUCTION IN PART OR WHOLE WITHOUT THE WRITTEN PERMISSION OF CASCADE MICROTECH, INC. IS PROHIBITED.	
CAD GENERATED DRAWING DO NOT MANUALLY UPDATE		7115 NORTHLAND TERRACE SUITE 400 BROOKLYN PARK, MN 55428 (763) 509-0066	
DRAWING APPROVALS		SCKT, 221GRY14X18-1.0	
DESIGN: S. Klanderud	DATE: 03/25/11	CASCAD MICROTECH	
APPROV: A. Seiberlich	DATE: 03/25/11	7115 NORTHLAND TERRACE SUITE 400 BROOKLYN PARK, MN 55428 (763) 509-0066	
LEGEND:		THIRD ANGLE PROJECTION	
\triangle NOTE CALLOUT	\triangle REVISION CHANGE	THIRD ANGLE PROJECTION	
\times REM NUMBER		THIRD ANGLE PROJECTION	
		SCALE: C	MATERIAL: SOLIDWORKS
		QUANTITY: 1	DESCRIPTION: 104670-0029
		SEE BOM	SHEET: A
			1 of 2

Device Specification					
Lead Count	N	221	Package Size	D	14.00
Columns	ND	13		E	18.00
Rows	NE	17	Ball Spacing	D1	12.00
Pitch	e	1.000		E1	16.00
Ball Size	b	0.50±0.05	Encapsulant/ Top Size	D2	n/a
Total Thickness	A	n/a		E2	n/a
Ball Height	A1	0.30 min	Pattern Style	Full	
Substrate Thickness	A2	n/a	Perimeter Rows	n/a	
Top Thickness	A3	n/a	Center Array	n/a	
Form Tolerances					
Edge	aaa	0.20	Bottom	ddd	0.15
Substrate top	bbb	0.20	Position	eee	0.20
	ccc	0.20	Position	fff	0.08

All dimensions are in millimeters.
*See footprint specification for pattern details.

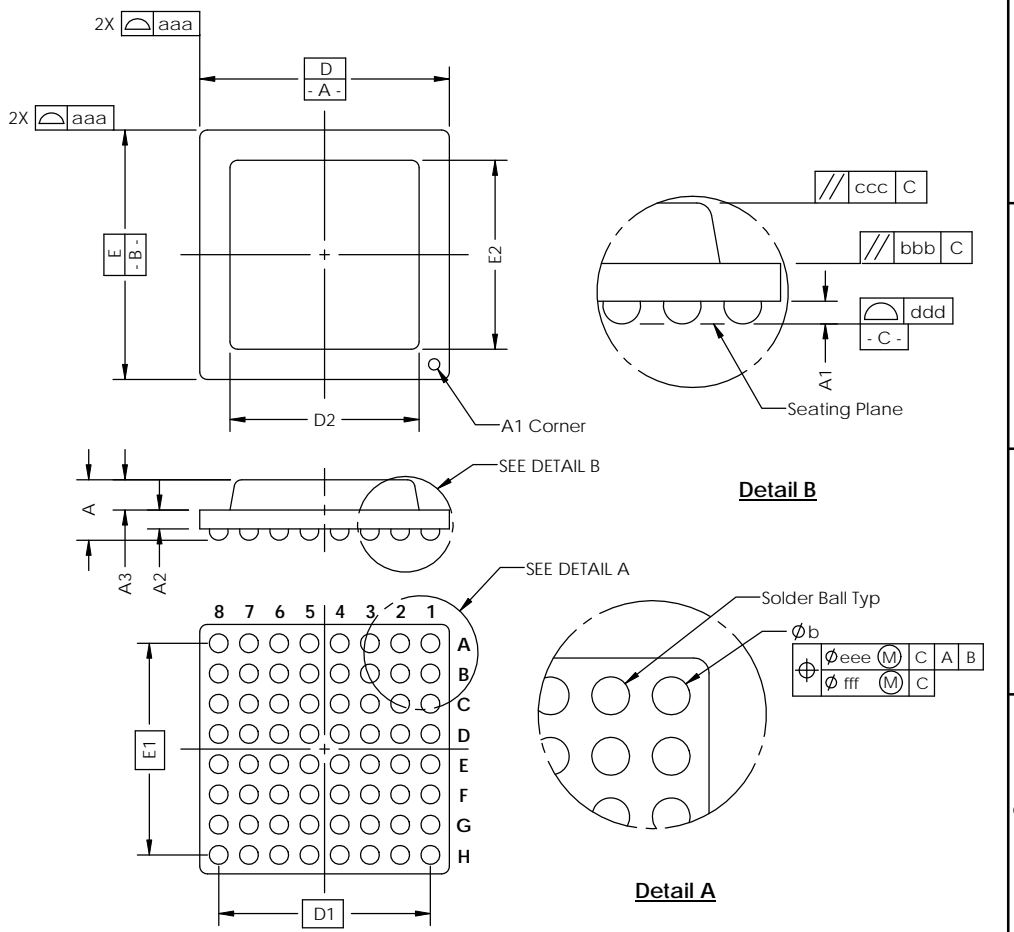
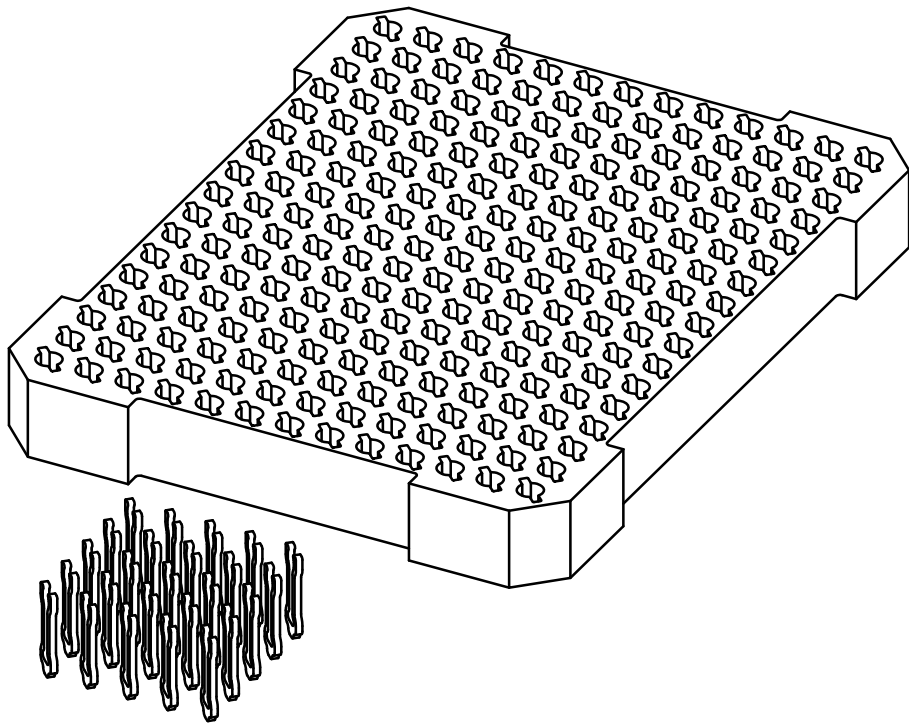

Generic Representation with Full Grid Array

THE INFORMATION CONTAINED IN THIS DRAWING IS THE SOLE PROPERTY OF CASCADE MICROTECH, INC.
ANY REPRODUCTION IN PART OR WHOLE WITHOUT THE WRITTEN PERMISSION OF CASCADE MICROTECH, INC. IS PROHIBITED.

UNLESS OTHERWISE SPECIFIED
- DIMENSIONS ARE IN MILLIMETERS
- DIMS APPLY AFTER PLATING
TOLERANCES UNLESS OTHERWISE NOTED: DECIMALS
ANGLES X.X ±0.25
X.XX ±0.10
X.XXX ±0.050

LEGEND:
 NOTE CALLOUT
 REVISION CHANGE
 ITEM NUMBER

7115 NORTHLAND TERRACE SUITE 400
BROOKLYN PARK, MN 55428
(763) 509-0066

SCKT, 221GRY14X18-1.0

DATE: C CAD FORNAT: SOLIDWORKS DRAWING NO: 104670-0029 REV: A
SCALE: MATERIAL: See Page 1 SHEET: 2 of 2